

NOTICE OF PUBLIC HEARING HAMBURG TOWNSHIP LIVINGSTON COUNTY, MICHIGAN NOTICE OF PUBLIC HEARING UPON A PROPOSED ROAD IMPROVEMENT PROJECT AND SPECIAL ASSESSMENT DISTRICT FOR DOWNING DRIVE

NOTICE IS HEREBY GIVEN:

(1) The Township Board of Hamburg Township, Livingston County, Michigan, in accordance with the laws of the State of Michigan, will hold a public hearing on Tuesday, February 18, 2020 at 5:30 p.m., at the Hamburg Township Hall, 10405 Merrill Road, Hamburg, Michigan 48139, to review the following proposed special assessment district:

DOWNING DRIVE - ROAD IMPROVEMENT SPECIAL ASSESSMENT DISTRICT
Hamburg Township, Livingston County, Michigan

**HAMBURG TOWNSHIP DOWNING DRIVE
ROAD IMPROVEMENT SPECIAL ASSESSMENT DISTRICT**

and to hear any objections thereto and to the proposed Project and to the petitions filed with the Township Board requesting the Project.

(2) The project (the "Project") will consist of saw cutting and removal of the existing chip seal, cold patch and HMA patching areas up to two-inches (2") thick from road and driveway approaches, cut existing gravel base to grade, proof roll grade to confirm stability, find grade and compact in preparation of new paving. The Contractor shall construct a final compacted four-inch (4") hot mixed asphalt surface comprised of a 2" MDOT #1100L, 20AA leveling course (213 tons), an SS-1h tack coat, and a 2" #1100T 20AA wearing course (213 tons). Existing asphalt or concrete driveways within three feet (3') of the edges of the road will be tied into the road with asphalt smoothly. Gravel driveways will have a one-foot (1') wide asphalt paved apron constructed off the edges of the road. The Project is being designed to serve the properties in the Special Assessment District, which properties are adjacent to the private portion of Downing Drive, and which properties are identified by the following permanent parcel numbers:

15-28-203-054	15-28-203-057	15-28-203-058	15-28-203-060
15-28-402-001	15-28-402-002	15-28-402-010	15-28-402-011
15-28-402-012	15-28-402-013	15-28-402-014	15-28-402-015
15-28-402-016	15-28-402-017	15-28-402-018	15-28-402-019
15-28-402-021	15-28-402-022	15-28-402-023	15-28-402-024
15-28-402-025	15-28-402-058	15-28-402-059	15-28-402-065
15-28-402-068	15-28-402-069	15-28-402-070	15-28-410-001
15-28-410-002	15-28-402-003	15-28-410-004	

(3) The Township plans on imposing special assessments on the properties located in the Special Assessment District to pay for the costs of the Project.

(4) The plans and cost estimates for the proposed Project, the boundaries of the Special Assessment District and the petitions filed in support of the Project are now on file in the office of the Township Clerk for public inspection. Periodic redeterminations of the cost of the Project may be made, and subsequent hearings shall not be required if such cost redeterminations do not increase the estimated cost of the Project by more than 10%. Any person objecting to the proposed Project, the petitions for the Project or the proposed Special Assessment District shall file an objection in writing with the Township Clerk before the close of the February 18th, 2020 hearing, or within such further time the Township Board may grant.

This notice is given by order of the Hamburg Township Board.

Dated: February 5th, 2020

Michael Dolan
Hamburg Township Clerk
10405 Merrill Rd. P.O. Box 157
Hamburg, MI 48139

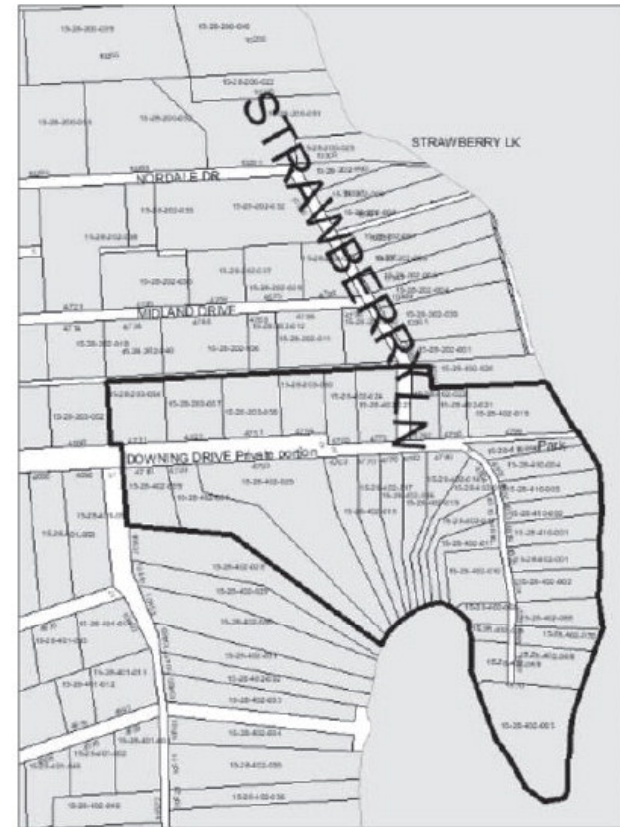

The general service area in which a proposed special assessment district is to be designated. The Hamburg Township Board of Trustees may adjust the district boundaries based upon property owner response in support of creating a road improvement special assessment district. **Proposed special assessment district boundary shown within thick black-lined area.**

